



Elishaw Row

Elishaw Row Eccles New Road, Salford

Salford



£145,000

Flat 12

Elishaw Row Eccles New Road, Salford

STYLISH TWO BEDROOM APARTMENT, within walking distance of SALFORD QUAYS & MEDIA CITY! Featuring a contemporary kitchen, a balcony and a modern, four-piece bathroom!

Council Tax band: A

Tenure: Leasehold

- Stylish Two Bedroom Apartment
- Within Walking Distance of Salford Quays and Media City
- Spacious Lounge
- Two Generously Sized Double Bedrooms
- Modern Four-Piece Bathroom
- Contemporary Fitted Kitchen
- Benefits from a Private Balcony
- Parking Available
- Close to Langworthy Tram Stop, which Provides Direct Access into Manchester City Centre
- Ideal First Time Home or Investment - Viewing is Highly Recommended!



HILLS



Entrance Hallway

Complete with ceiling spotlights and laminate flooring.

Lounge

13' 11" x 12' 0" (4.24m x 3.65m)

Complete with ceiling spotlights, double glazed window and wall mounted radiator. Fitted with laminate flooring.

Kitchen

9' 6" x 8' 0" (2.89m x 2.43m)

Featuring modern fitted units with integral hob, microwave oven and fridge freezer. Complete with ceiling spotlights.

Bedroom One

11' 7" x 11' 0" (3.53m x 3.36m)

Complete with a ceiling light point, double glazed window and wall mounted radiator. Fitted with carpet flooring.

Bedroom Two

13' 0" x 9' 2" (3.96m x 2.79m)

Complete with a ceiling light point, double glazed window and laminate flooring.

Bathroom

9' 1" x 6' 9" (2.76m x 2.07m)

Featuring a contemporary three-piece suite including a bath with shower over, hand wash basin and W.C.

Complete with ceiling spotlights, double glazed window, tiled walls and flooring.

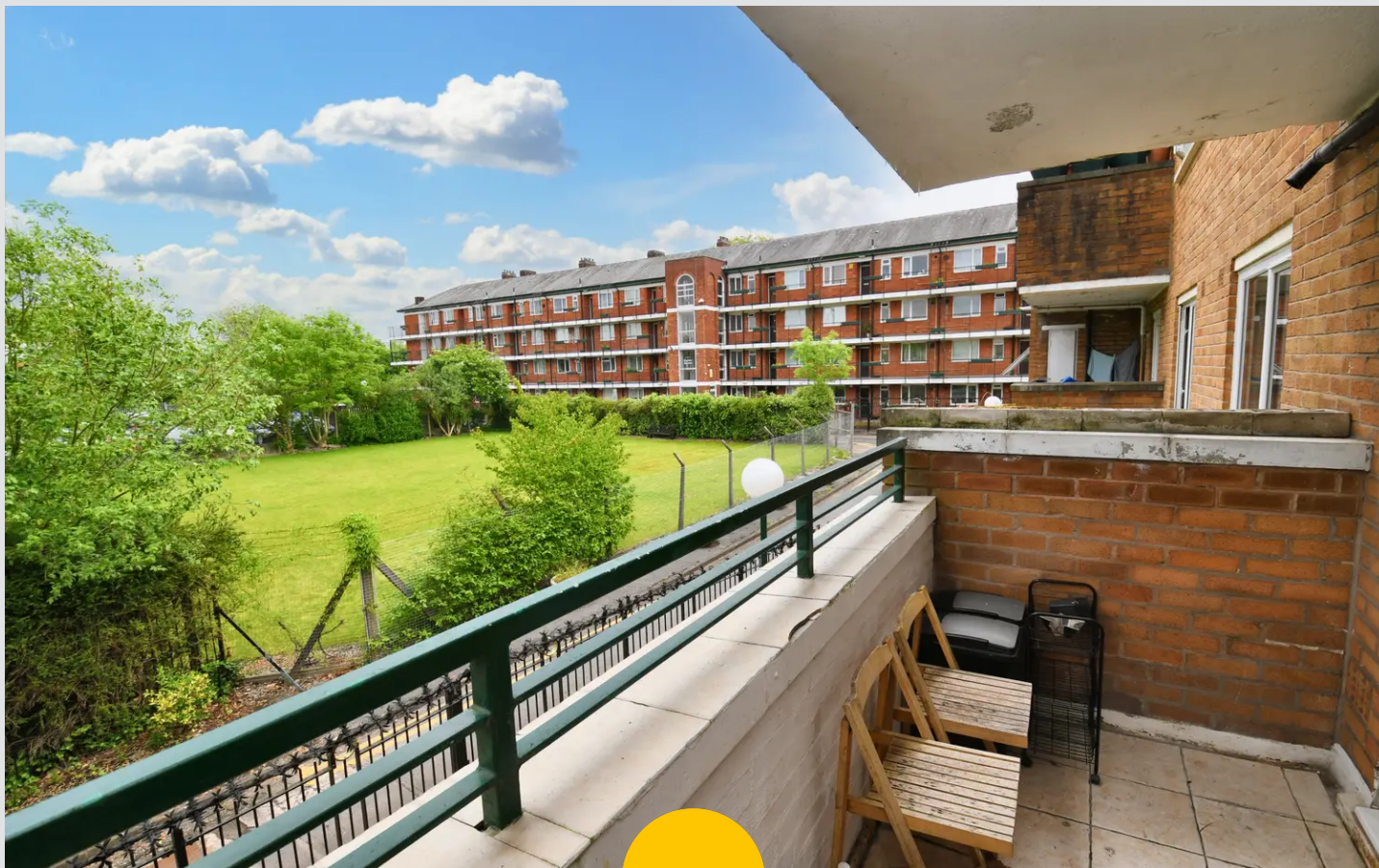

HILLS



Entrance Hallway

Complete with ceiling spotlights and laminate flooring.

Lounge

13' 11" x 12' 0" (4.24m x 3.65m)

Complete with ceiling spotlights, double glazed window and wall mounted radiator. Fitted with laminate flooring.

Kitchen

9' 6" x 8' 0" (2.89m x 2.43m)

Featuring modern fitted units with integral hob, microwave oven and fridge freezer. Complete with ceiling spotlights.

Bedroom One

11' 7" x 11' 0" (3.53m x 3.36m)

Complete with a ceiling light point, double glazed window and wall mounted radiator. Fitted with carpet flooring.

Bedroom Two

13' 0" x 9' 2" (3.96m x 2.79m)

Complete with a ceiling light point, double glazed window and laminate flooring.

Bathroom

9' 1" x 6' 9" (2.76m x 2.07m)

Featuring a contemporary three-piece suite including a bath with shower over, hand wash basin and W.C.

Complete with ceiling spotlights, double glazed window, tiled walls and flooring.



HILLS





HILLS



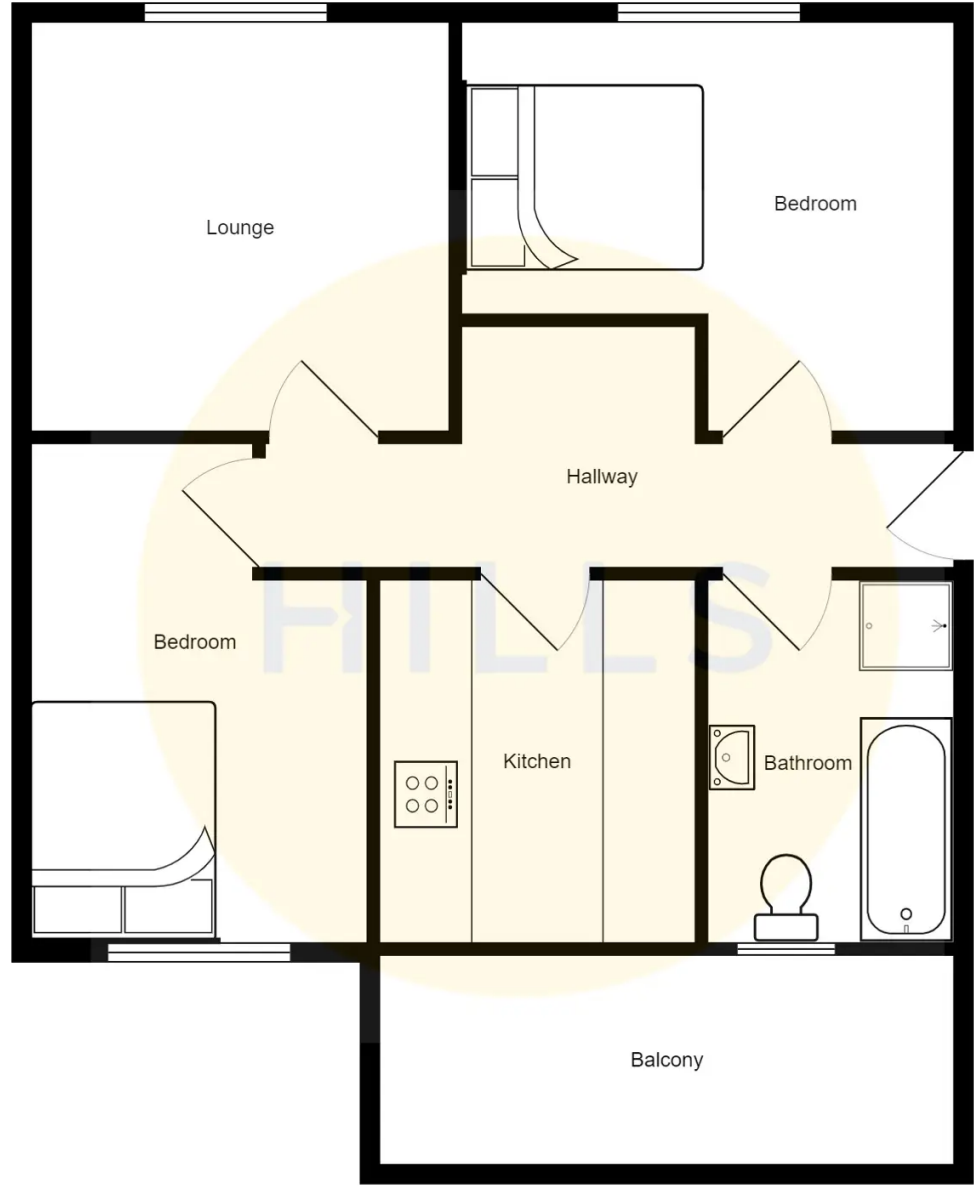



HILLS

Hills | Salfords Estate Agent

Hills Residential, Sentinel House Albert Street - M30 0SS

0161 707 4900

sales@hills.agency

www.hills.agency/



THE PROPERTY MISDESCRIPTIONS ACT 1991 The Agent has not tested any apparatus, equipment, fixtures and fittings or services and so cannot verify that they are in working order or fit for the purpose. A Buyer is advised to obtain verification from their Solicitor or Surveyor. References to the Tenure of a Property are based on information supplied by the Seller. The Agent has not had sight of the title documents. A Buyer is advised to obtain verification from their Solicitor. You are advised to check the availability of this property before travelling any distance to view. Every effort and precaution has been made to ensure these particulars are correct and not misleading but their accuracy is not guaranteed nor do they form part of any contract. If there is any point which is of particular importance to you, please contact us and we will provide any information you require. This is advisable, particularly if you intend to travel some distance to view the property. The mention of any appliances and services within these details does not imply that they are in full and efficient working order. These particulars are in draft form awaiting Vendors confirmation of their accuracy. These details must therefore be taken as a guide only.