



# Willow Tree Court Aldred Street, Eccles

Manchester



In Excess of £130,000



# Willow Tree Court

Manchester

Modern two bed flat in residential development. Open plan living, fitted kitchen, two double bedrooms, residents' parking. Close to amenities, transport links. Ideal first home/downsize. Council Tax band: B

Tenure: Leasehold

- Beautifully Presented Second Floor Apartment
- Fabulous Open Plan Living and Dining Space
- Modern Fitted Kitchen with Ample Storage & Serving Space
- Two Generous Double Bedrooms
- Timeless White Three Piece Bathroom Suite
- Well Kept Communal Area & Gardens
- Residents Parking Space
- Well Served by Public Transport & Motorway Links and Close to Many Local Amenities





### Entrance Hallway

Featuring ceiling light point.

### Lounge

12' 4" x 12' 10" (3.76m x 3.90m)

Featuring ceiling light point, double glazed front window, electric radiator. Fitted with laminate flooring.

### Kitchen

11' 0" x 8' 0" (3.36m x 2.44m)

Featuring complementary wall and base units with integral hob and oven. Space for a washing machine and undercounter fridge. Complete with a ceiling light point, double glazed front window and lino flooring.

### Bedroom One

13' 5" x 9' 6" (4.09m x 2.89m)

Featuring built-in wardrobes. Complete with a ceiling light point, double glazed rear window and electric radiator. Fitted with laminate flooring.

### Bedroom Two

7' 5" x 8' 3" (2.25m x 2.52m)

Featuring ceiling light point, double glazed rear window, electric radiator. Fitted with carpet flooring.

### Bathroom

7' 11" x 5' 7" (2.42m x 1.71m)

Featuring three piece suite including hand wash basin, w/c, bath with a shower overhead. Complete with ceiling light point. Fitted with lino flooring and tiled walls.



HILLS







HILLS



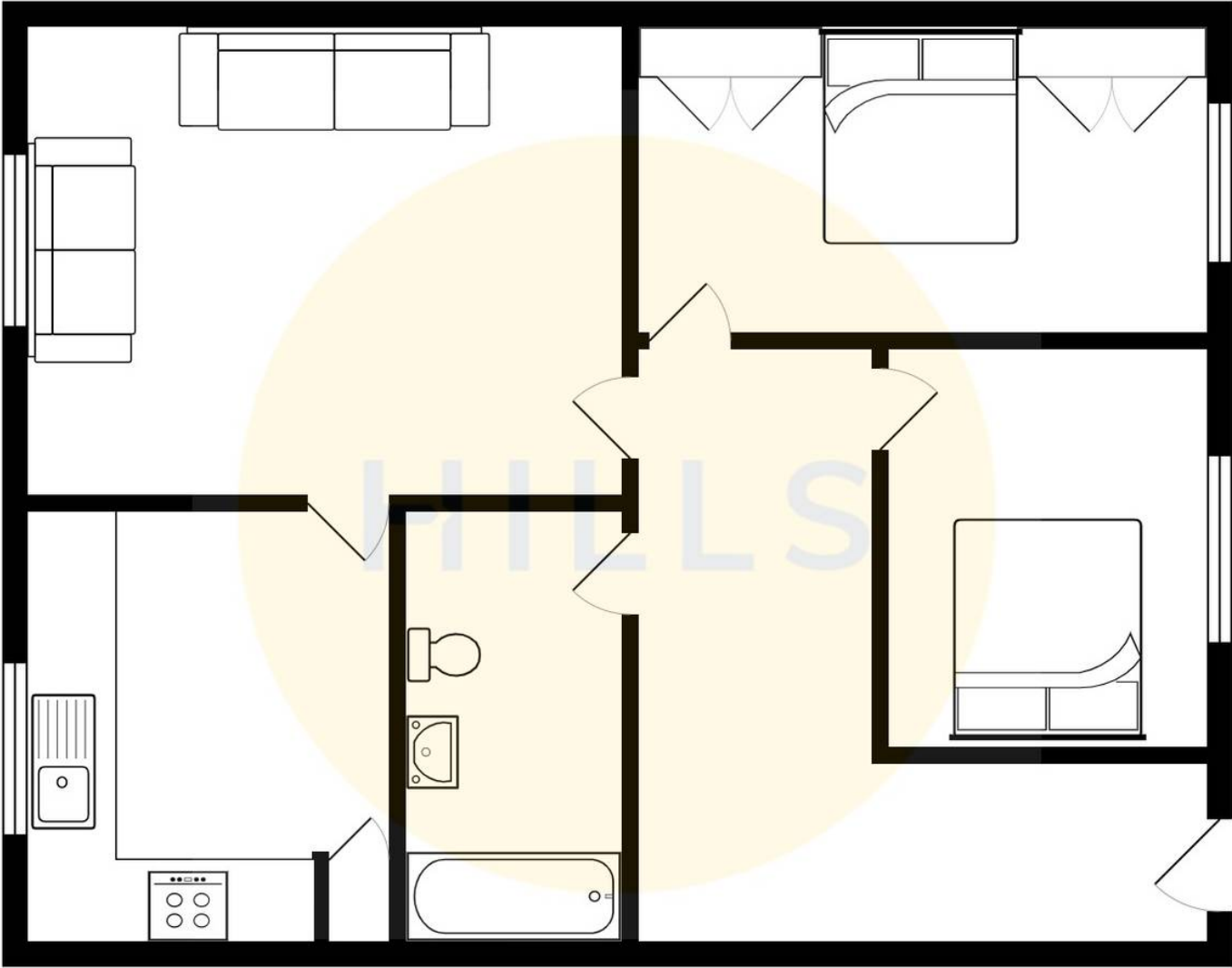





## Hills | Salfords Estate Agent

Hills Residential, Sentinel House Albert Street - M30 0SS

0161 707 4900

[sales@hills.agency](mailto:sales@hills.agency)

[www.hills.agency/](http://www.hills.agency/)



THE PROPERTY MISDESCRIPTIONS ACT 1991 The Agent has not tested any apparatus, equipment, fixtures and fittings or services and so cannot verify that they are in working order or fit for the purpose. A Buyer is advised to obtain verification from their Solicitor or Surveyor. References to the Tenure of a Property are based on information supplied by the Seller. The Agent has not had sight of the title documents. A Buyer is advised to obtain verification from their Solicitor. You are advised to check the availability of this property before travelling any distance to view. Every effort and precaution has been made to ensure these particulars are correct and not misleading but their accuracy is not guaranteed nor do they form part of any contract. If there is any point which is of particular importance to you, please contact us and we will provide any information you require. This is advisable, particularly if you intend to travel some distance to view the property. The mention of any appliances and services within these details does not imply that they are in full and efficient working order. These particulars are in draft form awaiting Vendors confirmation of their accuracy. These details must therefore be taken as a guide only.