



Barff Road

Salford



£150,000

Barff Road

Salford

This SPACIOUS, THREE BEDROOM, BAY-FRONTED TERRACED property is full of potential, and is situated in a convenient location close to Salford Royal Hospital and Weaste Tram Stop – which provides direct access into Salford Quays, Media City and Manchester City Centre!

Council Tax band: A

Tenure: Freehold

- Spacious Three Bedroom, Bay-Fronted Terraced Property
- Within Walking Distance of Salford Royal Hospital, Buile Hill Park and Local Schooling
- Close to Weaste Tram Stop, which Provides Direct Access into Salford Quays, Media City and Manchester City Centre
- Bay-Fronted Lounge and a Spacious Dining Room
- Fitted Kitchen and a Three-Piece Family Bathroom
- Low-Maintenance Courtyard Gardens to the Front and Rear
- Ideal for Someone Looking to Put Their Own Stamp on a Property
- Viewing is Highly Recommended!



HILLS

Lounge

14' 4" x 10' 11" (4.37m x 3.34m)

Featuring ceiling light point, single glazed bay window, wall - mounted radiator. Fitted with laminate flooring.

Kitchen

13' 7" x 8' 9" (4.13m x 2.67m)

Featuring complementary fitted units with integral hob and oven. Space for washer. Complete with two ceiling light points, single glazed window, wall - mounted radiator. Fitted with tiled flooring.

Dining room

14' 4" x 15' 9" (4.36m x 4.80m)

Featuring ceiling light point, single glazed window.

Landing

Complete with a ceiling light point and carpet flooring.

Bedroom One

14' 4" x 11' 2" (4.37m x 3.40m)

Featuring ceiling light point, two single glazed windows, wall - mounted radiator. Fitted with carpet flooring.

Bedroom Two

11' 9" x 8' 11" (3.59m x 2.71m)

Featuring ceiling light point, single glazed window, wall - mounted radiator. Fitted with carpet flooring.

Bedroom Three

9' 0" x 8' 11" (2.75m x 2.72m)

Featuring three piece suite including bath with shower overhead, hand wash basin, w/c. Complete with a ceiling light point, single glazed window. Fitted with tiled walls and carpet flooring.



Bathroom

6' 2" x 5' 6" (1.88m x 1.67m)

Featuring a three-piece suite including bath with shower over, hand wash basin and W.C. Complete with a ceiling light point, single glazed window and wall mounted radiator. Fitted with tiled walls and carpet flooring.

External

To the front of the property is a low maintenance paved garden.



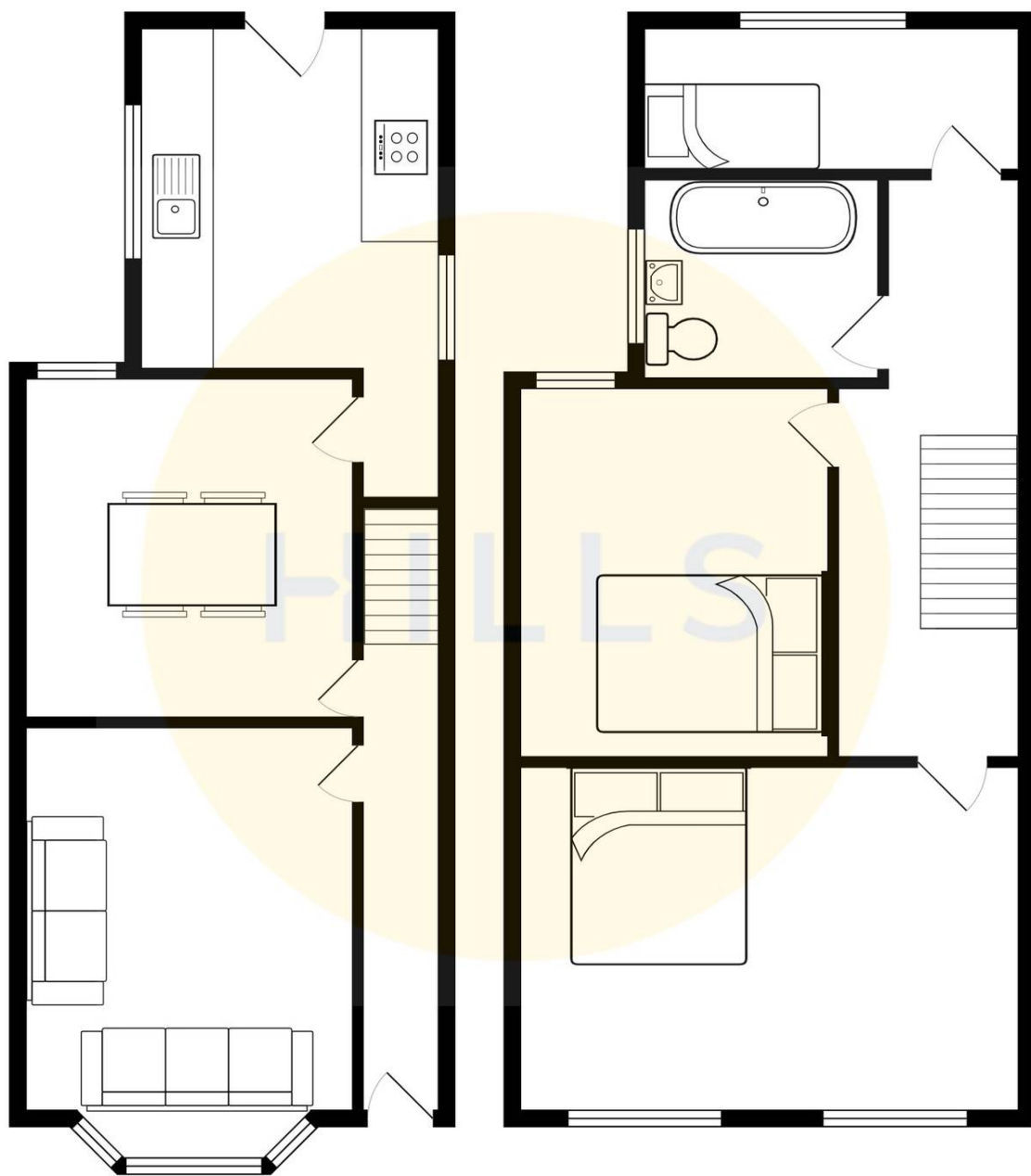



Hills | Salfords Estate Agent

Hills Residential, Sentinel House Albert Street - M30 0SS

0161 707 4900

sales@hills.agency

www.hills.agency/



THE PROPERTY MISDESCRIPTIONS ACT 1991 The Agent has not tested any apparatus, equipment, fixtures and fittings or services and so cannot verify that they are in working order or fit for the purpose. A Buyer is advised to obtain verification from their Solicitor or Surveyor. References to the Tenure of a Property are based on information supplied by the Seller. The Agent has not had sight of the title documents. A Buyer is advised to obtain verification from their Solicitor. You are advised to check the availability of this property before travelling any distance to view. Every effort and precaution has been made to ensure these particulars are correct and not misleading but their accuracy is not guaranteed nor do they form part of any contract. If there is any point which is of particular importance to you, please contact us and we will provide any information you require. This is advisable, particularly if you intend to travel some distance to view the property. The mention of any appliances and services within these details does not imply that they are in full and efficient working order. These particulars are in draft form awaiting Vendors confirmation of their accuracy. These details must therefore be taken as a guide only.