



Sartoria Court, Half Edge Lane

Manchester



In Excess of £170,000

Sartoria Court

Manchester

Nestled within the popular Monton Village, this lovely two-bedroom apartment offers a prime location with a fine array of bars, shops, and restaurants at your doorstep!

Council Tax band: B

Tenure: Leasehold

- Lovely Two Bedroom Apartment
- Situated in Monton Village, which is Host to a Fine Array of Bars, Shops and Restaurants
- Contemporary, Open Plan Living, Dining and Kitchen Area
- Modern Fitted Kitchen Complete with Integrated Appliances
- Two Generously-Sized Bedrooms, with a Bay Window in the Main Bedroom
- Stylish Three-Piece Bathroom
- Communal Parking Available
- Close to Excellent Transport Links into Salford Quays, Media City and Manchester City Centre
- Great First Time Home or Investment, Viewing is Highly Recommended!



HILLS

Reception Room

15' 0" x 15' 2" (4.57m x 4.63m)

Complete with a ceiling light point, double glazed window and electric radiator. Fitted with laminate flooring.

Kitchen

6' 9" x 11' 3" (2.06m x 3.44m)

Featuring complementary wall and base units with integral hob, oven, dishwasher and fridge freezer. Space for a washing machine. Complete with ceiling spotlights.

Bathroom

9' 9" x 5' 10" (2.96m x 1.78m)

Featuring a three-piece suite including bath, hand wash basin and W.C. Complete with ceiling spotlights, heated towel rail and lino flooring.

Bedroom One

14' 2" x 12' 1" (4.33m x 3.68m)

Complete with a ceiling light point, double glazed bay window and wall mounted radiator. Fitted with laminate flooring.

Bedroom Two

7' 8" x 14' 9" (2.33m x 4.50m)

Complete with a ceiling light point, double glazed window and electric radiator. Fitted with laminate flooring.



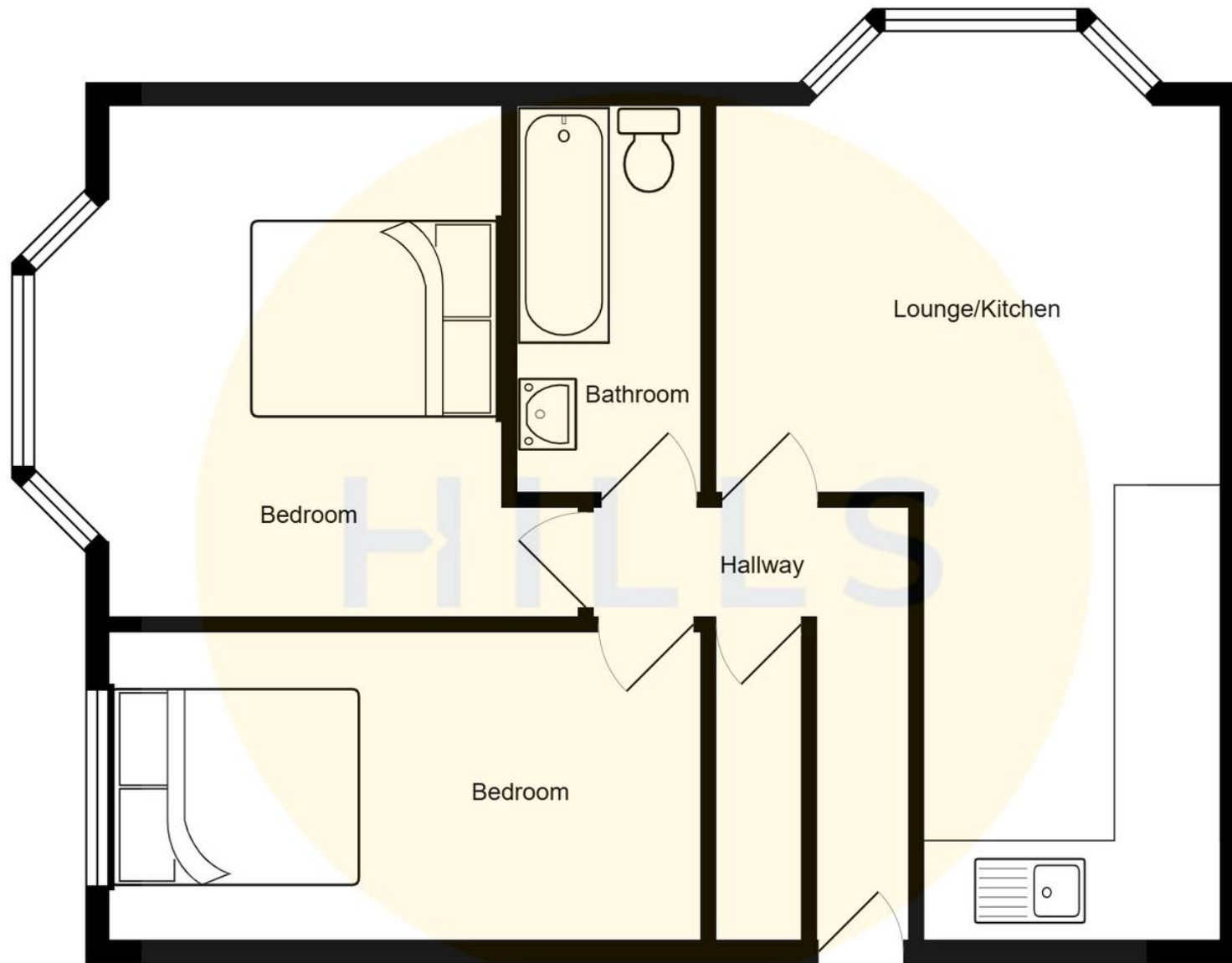



Hills | Salfords Estate Agent

Hills Residential, Sentinel House Albert Street – M30 0SS

0161 707 4900

sales@hills.agency

www.hills.agency/



THE PROPERTY MISDESCRIPTIONS ACT 1991 The Agent has not tested any apparatus, equipment, fixtures and fittings or services and so cannot verify that they are in working order or fit for the purpose. A Buyer is advised to obtain verification from their Solicitor or Surveyor. References to the Tenure of a Property are based on information supplied by the Seller. The Agent has not had sight of the title documents. A Buyer is advised to obtain verification from their Solicitor. You are advised to check the availability of this property before travelling any distance to view. Every effort and precaution has been made to ensure these particulars are correct and not misleading but their accuracy is not guaranteed nor do they form part of any contract. If there is any point which is of particular importance to you, please contact us and we will provide any information you require. This is advisable, particularly if you intend to travel some distance to view the property. The mention of any appliances and services within these details does not imply that they are in full and efficient working order. These particulars are in draft form awaiting Vendors confirmation of their accuracy. These details must therefore be taken as a guide only.